

Key Plan Scale 1:500

Buttermere House
 Apartment 4
 Ground Floor Layout

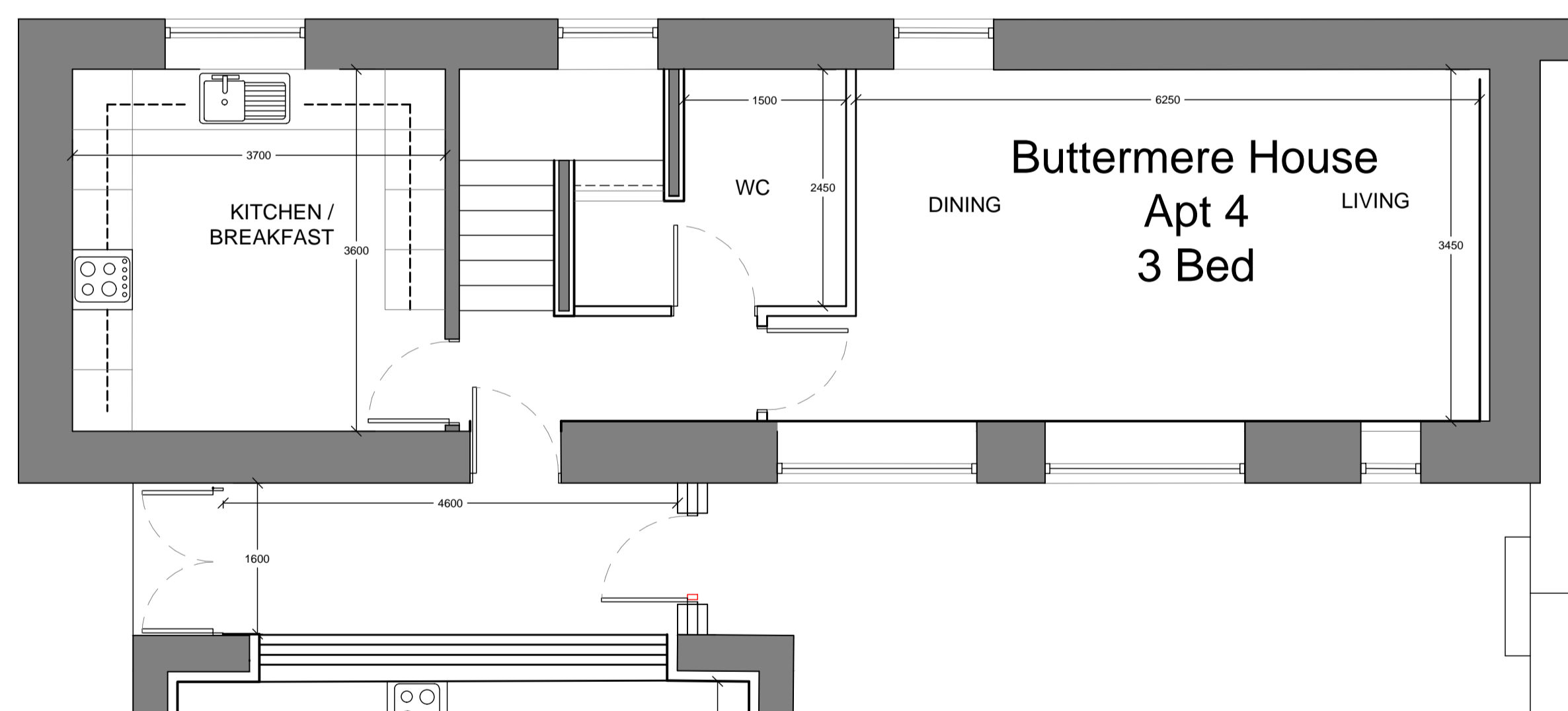

Floor Area -
 Brochure (110 Sqm / 1184 SqF)
 As Built (110 Sqm / 1184 SqF)

Buttermere House
 Apartment 4
 First Floor Layout

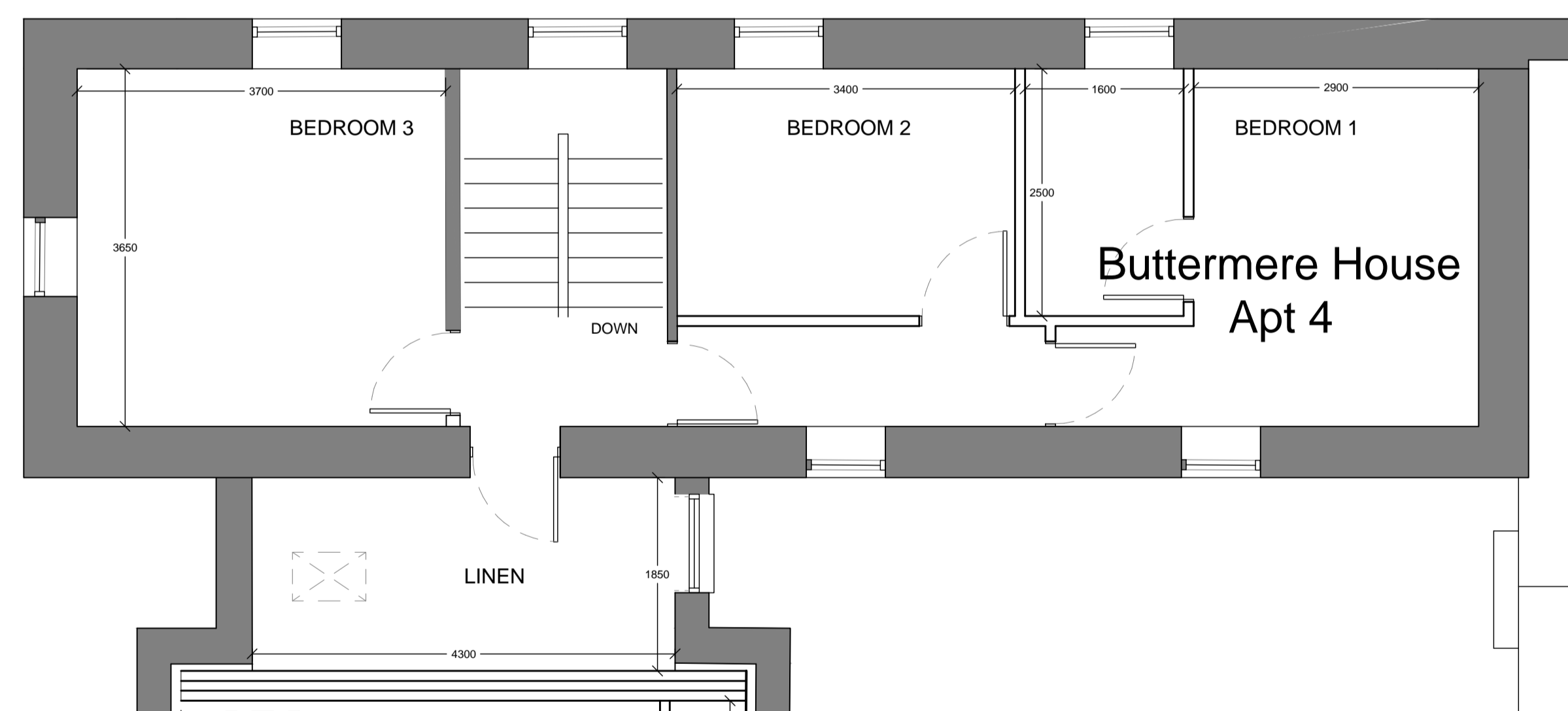

- Status:
- Feasibility
 - Planning Approval
 - Building Regulations
 - Tender
 - Construction

Project: Residential Development
 Eden Grove, Bolton Nr Appleby
 Cumbria, CA16 6FS

Client: Eden Grove Investment
 Properties Ltd.

Drawing Title: Building K
 Buttermere House Apt 4

| Project No. | Drwg No. | Revision | Scale | Date |
|-------------|----------|----------|----------|----------|
| 391 | 185 | | 1:50 @A1 | Jan 2021 |

